

osnova stana
R = 1:100

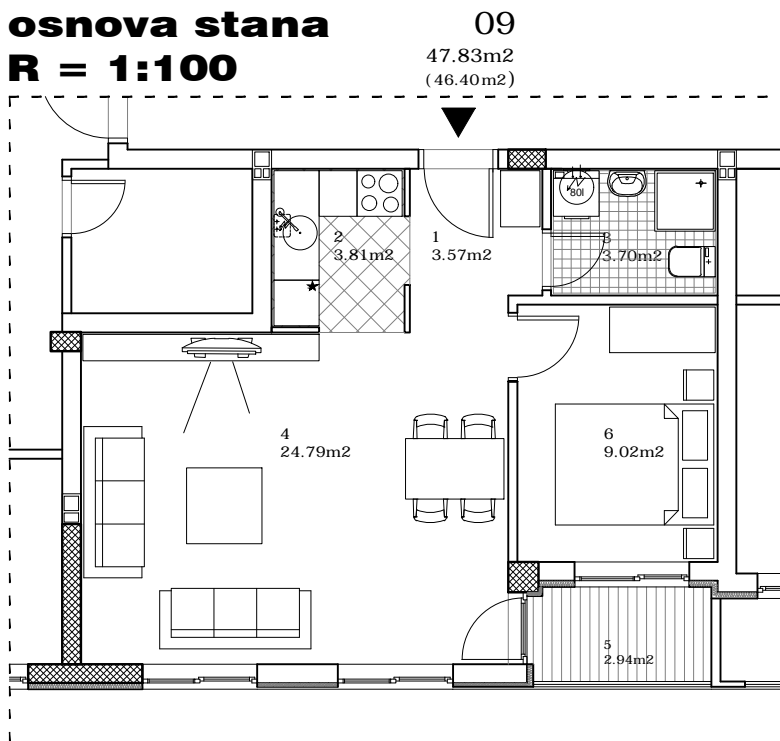

STAN 9 - DVOSOBAN

1	ULAZ	3.57 m²
2	KUHINJA	3.81 m²
3	KUPATILO	3.70 m²
4	DNEVNA SOBA	24.79 m²
5	LOĐA	2.94 m²
6	SPAVAČA SOBA	9.02 m²
UKUPNO STAN 9 :		47.83 m²
		- 3% 46.40 m²



ulica SLOVAČKA 9

I SPRAT/STAN 9